

Ball Valves

Brass Series 520



Product Features:

- Forged brass body
- Chrome plated brass ball
- PTFE seats/seals
- Fluorocarbon Stem O-rings
- Steel handle

Style:

- V-Valve

Type:

- 520-Female/Female NPT Ports

Material:

- P-Brass

Options:

- 04-Tee Handle

Specifications:

Pressure Range:

- 600 WOG Cold Non-shock 1/4" – 2"
- 450 WOG, Cold Non-shock 1/2" – 3"
- Saturated Steam up to 150 psi
- Vacuum Service to 29 Inches Hg

Temperature Range

- -40° to +350°F

U.L. LISTED	
CATEGORY	
YSDT	LP-GAS SHUT-OFF VALVES
YRBX	FLAMMABLE LIQUID SHUT-OFF VALVES
YRPV	GAS SHUT-OFF VALVES
YQNZ	COMPRESSED GAS SHUT-OFF VALVES

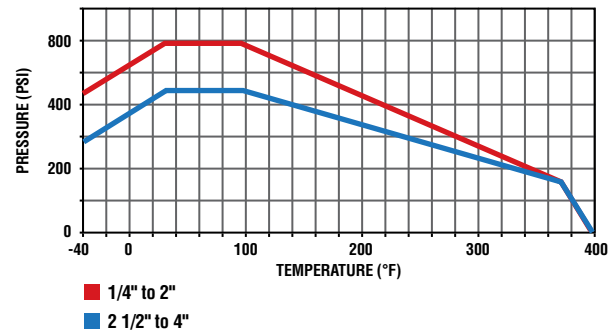

Brass Ball Valve XV520P

PART NO.	PIPE THREAD	B OCTAGON	C OCTAGON	H	L	M	N	D FLOW Ø
XV520P-4	1/4-18	.79	.79	3.94	4.83	1.77	1.50	.310
XV520P-6	3/8-18	.79	.79	3.94	4.83	1.77	1.50	.400
XV520P-8	1/2-14	.98	.98	3.94	5.10	2.32	1.69	.600
XV520P-12	3/4-14	1.22	1.22	4.72	5.98	2.52	1.97	.790
XV520P-16	1-11.5	1.57	1.57	4.72	6.32	3.19	2.13	1.000
XV520P-20	1-1/4	1.93	1.93	6.22	8.05	3.66	2.82	1.250
XV520P-24	1-1/2	2.13	2.13	6.22	8.23	4.02	3.06	1.570
XV520P-32	2	2.69	2.69	6.22	8.58	4.76	3.33	2.000
XV520P-40	2-1/2	3.35	3.35	10.04	13.11	6.14	5.20	2.520
XV520P-48	3	3.89	3.89	10.04	13.52	6.97	5.51	3.000

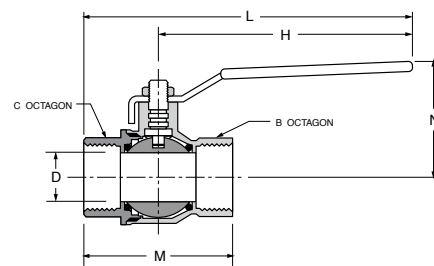



YQNZ.MH12813 Compressed Gas Shutoff Valves

[Page Bottom](#)

Compressed Gas Shutoff Valves

[See General Information for Compressed Gas Shutoff Valves](#)

PARKER-HANNIFIN CORP

MH12813

300 PARKER DR
OTSEGO, MI 49078 USA

Gas line service valves for air, natural and manufactured gases, Series V520P@, 2-1/2, 3 and 4 in., rated 450 psig. Series V500P@, 2-1/2, 3 and 4 in., rated 450 psig.

@ - May be prefixed with X to indicate packaging quantity.

Trademark and/or Tradename: "P-H"

[Last Updated](#) on 2014-10-08

[Questions?](#)

[Print this page](#)

[Terms of Use](#)

[Page Top](#)

© 2016 UL LLC

The appearance of a company's name or product in this database does not in itself assure that products so identified have been manufactured under UL's Follow-Up Service. Only those products bearing the UL Mark should be considered to be Certified and covered under UL's Follow-Up Service. Always look for the Mark on the product.

UL permits the reproduction of the material contained in the Online Certification Directory subject to the following conditions: 1. The Guide Information, Assemblies, Constructions, Designs, Systems, and/or Certifications (files) must be presented in their entirety and in a non-misleading manner, without any manipulation of the data (or drawings). 2. The statement "Reprinted from the Online Certifications Directory with permission from UL" must appear adjacent to the extracted material. In addition, the reprinted material must include a copyright notice in the following format: "© 2016 UL LLC".



YRBX.MH12813 Flammable Liquid Shutoff Valves

[Page Bottom](#)

Flammable Liquid Shutoff Valves

[See General Information for Flammable Liquid Shutoff Valves](#)

PARKER-HANNIFIN CORP

MH12813

300 PARKER DR
OTSEGO, MI 49078 USA

Shut off valves, Series V520P@, 2-1/2, 3 and 4 in., rated 450 psig. Series V500P@, 2-1/2, 3 and 4 in., rated 450 psig.

@ - May be prefixed with X to indicate packaging quantity.

Trademark and/or Tradename: "P-H"

[Last Updated](#) on 2014-10-08

[Questions?](#)

[Print this page](#)

[Terms of Use](#)

[Page Top](#)

© 2016 UL LLC

The appearance of a company's name or product in this database does not in itself assure that products so identified have been manufactured under UL's Follow-Up Service. Only those products bearing the UL Mark should be considered to be Certified and covered under UL's Follow-Up Service. Always look for the Mark on the product.

UL permits the reproduction of the material contained in the Online Certification Directory subject to the following conditions: 1. The Guide Information, Assemblies, Constructions, Designs, Systems, and/or Certifications (files) must be presented in their entirety and in a non-misleading manner, without any manipulation of the data (or drawings). 2. The statement "Reprinted from the Online Certifications Directory with permission from UL" must appear adjacent to the extracted material. In addition, the reprinted material must include a copyright notice in the following format: "© 2016 UL LLC".



YRPV.MH12813 Gas Shutoff Valves

[Page Bottom](#)

Gas Shutoff Valves

[See General Information for Gas Shutoff Valves](#)

PARKER-HANNIFIN CORP

MH12813

300 PARKER DR
OTSEGO, MI 49078 USA

Shut off valves Manual for LP natural and manufactured gases, Series V520P@, 2-1/2, 3 and 4 in., rated 450 psig. Series V500P@, 2-1/2, 3 and 4 in., rated 450 psig.

@ - May be prefixed with X to indicate packaging quantity.

Trademark and/or Tradename: "P-H"

[Last Updated](#) on 2014-10-08

[Questions?](#)

[Print this page](#)

[Terms of Use](#)

[Page Top](#)

© 2016 UL LLC

The appearance of a company's name or product in this database does not in itself assure that products so identified have been manufactured under UL's Follow-Up Service. Only those products bearing the UL Mark should be considered to be Certified and covered under UL's Follow-Up Service. Always look for the Mark on the product.

UL permits the reproduction of the material contained in the Online Certification Directory subject to the following conditions: 1. The Guide Information, Assemblies, Constructions, Designs, Systems, and/or Certifications (files) must be presented in their entirety and in a non-misleading manner, without any manipulation of the data (or drawings). 2. The statement "Reprinted from the Online Certifications Directory with permission from UL" must appear adjacent to the extracted material. In addition, the reprinted material must include a copyright notice in the following format: "© 2016 UL LLC".



YSDT.MH12813 LP-Gas Shutoff Valves

[Page Bottom](#)

LP-Gas Shutoff Valves

[See General Information for LP-Gas Shutoff Valves](#)

PARKER-HANNIFIN CORP

MH12813

300 PARKER DR
OTSEGO, MI 49078 USA

Shut off valves Model(s) V520P(@)(max working pressure 450 psig for 2-1/2, 3, 4 in. sizes)

XV500P (max working pressure 450 psig for 2-1/2, 3, 4 in. sizes)

(@) - may be prefixed with X to indicate packaging quantity

Trademark and/or Tradename: "P-H"

[Last Updated](#) on 2014-10-07

[Questions?](#)

[Print this page](#)

[Terms of Use](#)

[Page Top](#)

© 2016 UL LLC

The appearance of a company's name or product in this database does not in itself assure that products so identified have been manufactured under UL's Follow-Up Service. Only those products bearing the UL Mark should be considered to be Certified and covered under UL's Follow-Up Service. Always look for the Mark on the product.

UL permits the reproduction of the material contained in the Online Certification Directory subject to the following conditions: 1. The Guide Information, Assemblies, Constructions, Designs, Systems, and/or Certifications (files) must be presented in their entirety and in a non-misleading manner, without any manipulation of the data (or drawings). 2. The statement "Reprinted from the Online Certifications Directory with permission from UL" must appear adjacent to the extracted material. In addition, the reprinted material must include a copyright notice in the following format: "© 2016 UL LLC".