

SH. 1
OF 1

CAT NO

3657U

CUSTOMER DIMENSIONS

DO NOT
SEPARATE
PRINT FROM
WORK

LOT NO

OPER

TOOLS

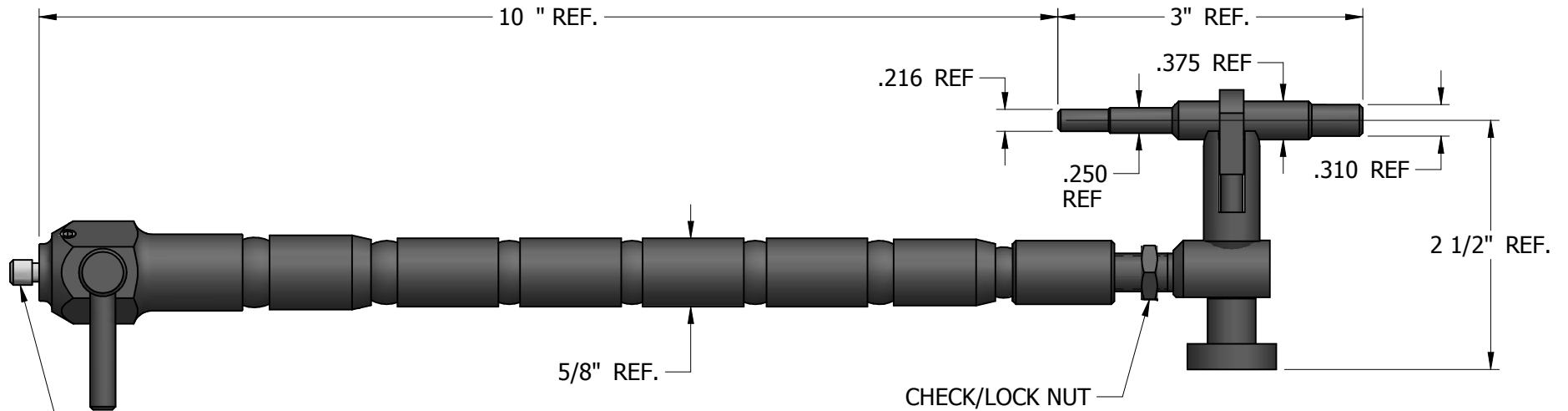

1/4-20 UNC 2A
P.D. .2164/.2127

5/8" REF.

.216 REF

3" REF.

.375 REF

.250
REF

.310 REF

2 1/2" REF.

CHECK/LOCK NUT

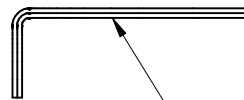

2.0 mm HEX KEY

REV	DESCRIPTION	DATE	BY
DR	DRH	CHK	DATE

FLEXIBLE INDICATOR
STAND ASSEMBLY

THE L.S. STARRETT CO.
ATHOL, MASS.

FRACTIONAL TOLERANCE +/- 1/64 UNLESS OTHERWISE NOTED